



**WHEELS**



Stunning design elements blend seamlessly throughout WHEELS to produce a unique environment of unsurpassed elegance. The Main Salon features a state-of-the-art entertainment system and wet bar aft with dazzling views. The formal Dining Salon accommodates twelve guests at the 19th century Carolina Walnut dining table.

MAIN SALON





Retreat to the opulent full-beam Master Stateroom designed with every detail in mind. The spacious suite is approached through the well-equipped office area and insures ultimate relaxation featuring a sophisticated entertainment system and opulent marble bathroom with Jacuzzi tub.



Spacious guest accommodations include three king staterooms, one queen and one twin stateroom, exquisitely designed with rich woods. Each features a 32" Plasma TV, cedar closet, and marble ensuite bathroom.

In the Skylounge relax around the coffee table or at the sophisticated walnut and onyx bar, the perfect spot to enjoy an aperitif, a magnificent view, and recount the day's adventures.



GUEST KING STATEROOM



GUEST TWIN STATEROOM



SKYLounge VIP STATEROOM





Three exterior decks will inspire those who want to take full advantage of the outdoors. Enjoy a refreshing beverage and panoramic view from the sundeck Jacuzzi, plunge into dazzling turquoise waters off the swim platform, or simply be soothed by the ocean breeze while savoring a romantic meal alfresco.





### SPECIFICATIONS

SLEEPS 12 IN 6 CABINS  
 LENGTH 164ft (50.0m)  
 BEAM 28ft (8.5m)  
 ENGINES 2 x CAT 3512B 2,250 hp  
 FLAG United States  
 DRAFT 8ft 0in (2.4m)  
 TYPE Power yacht  
 YEAR BUILT 2009  
 SPEED CRUISE 17kts / MAX 19kts  
 DESIGNER Scott Carpenter  
 BUILDER Trinity Yachts  
 STABILIZERS At Anchor (0 Speed)  
 CREW 8

### FEATURES

36' Yellow Fin with 3 x 275 hp engines  
 20' Nautica Diesel  
 17' Wide Body rescue boat w/115 hp  
 (2)3 seater Yamaha waverunners  
 12 sets of SCUBA gear  
 underwater scooters  
 Snorkelling gear  
 assorted towable toys  
 Fishing equipment  
 Elliptical machine  
 Barbeque  
 Swim platform  
 Jacuzzi  
 WIFI and Internet  
 SATCOM

Photos: Jim Raycroft  
 Design and Production: IYC. Fort Lauderdale, FL 1009

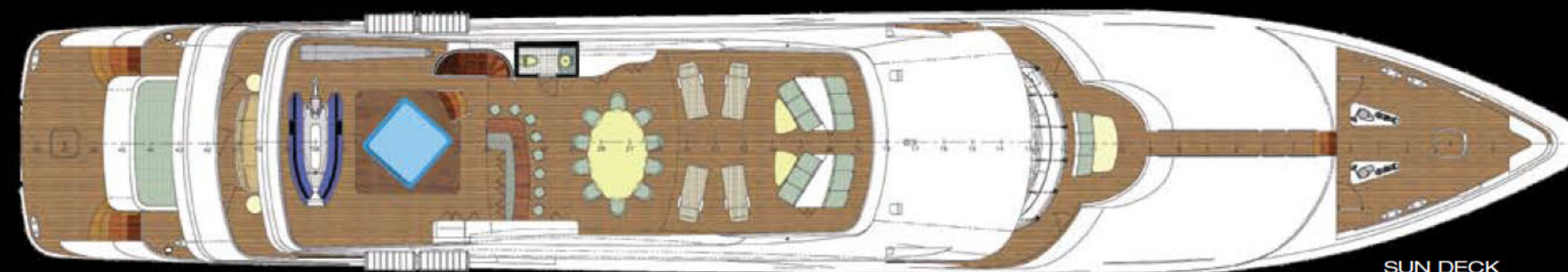

SUN DECK



BRIDGE DECK

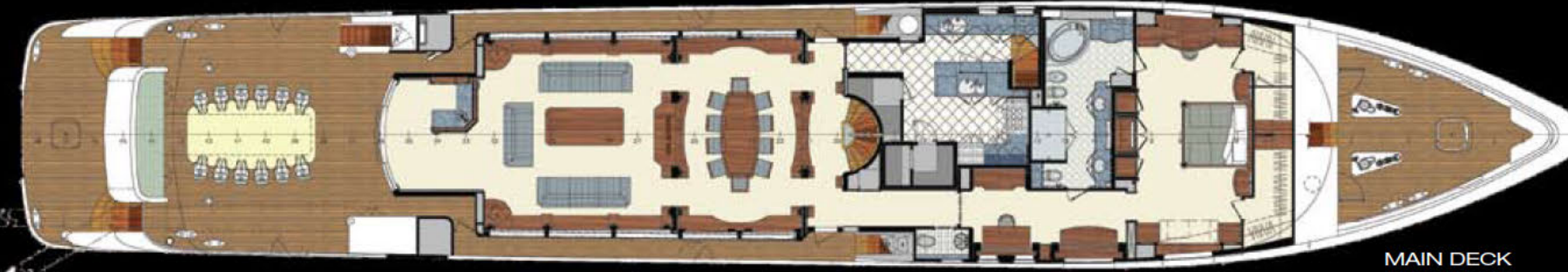

MAIN DECK



LOWER DECK





WHEELS S

# PARADISE

---

## YACHT CHARTERS

[HOME](#) [DESTINATIONS](#) [YACHT SEARCH](#) [CHARTER TERMS](#) [YACHT PURCHASE](#) [NEWSLETTERS](#) [BLOG](#) [CONTACT](#)



[www.ParadiseYachtCharters.com](http://www.ParadiseYachtCharters.com)  
[rjr@anythingonthewater.com](mailto:rjr@anythingonthewater.com)  
(954) 462-0091